



Falcon 2

Tablet POS

With a variety of cases and docks to provide different functions, the Falcon 2 is a highly flexible tablet POS device. Accompanied by a powerful processor for complex transactions, be rest assured that the Falcon 2 can overcome any business environment and excel at every task.



reddot winner 2025

Compatible with a range of casing

Falcon 2 is designed to seamlessly integrate with a variety of case variations well suited for different types of settings.



Protective Case

Provides strong protection to excel in harsh environments.

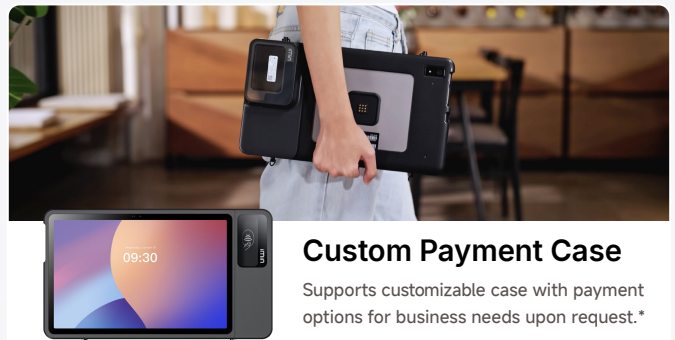

Custom Payment Case

Supports customizable case with payment options for business needs upon request.*

* iMin does not offer financial modules. We only sell the casing designed to house them.

Magnetic dock design

Falcon 2 is integrated with a magnetic dock design so that it can easily attach onto different docks to give a completely different experience.



Basic Dock

A basic dock for reliable docking.

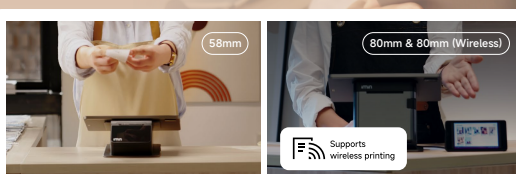

High-Speed Thermal Printer Dock

Equipped with 58mm/80mm/80mm (Wireless) high speed thermal printer.

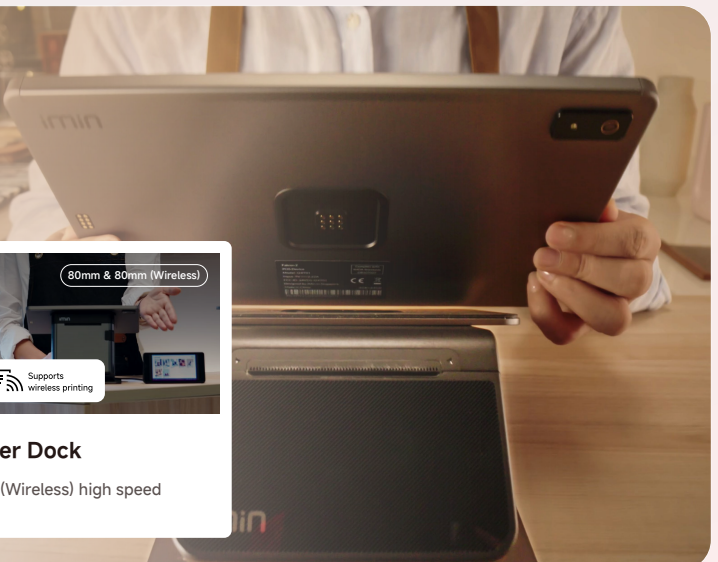

A comprehensive range of features for any business



Falcon 2 anticipates all possible needs that business operations may require, and offers an extensive range of features to thrive in different business environments.

5-inch Secondary Display

Supports customer display and signing.



10.95" Display that has 8000mAh Large Battery

10.95" tablet that has extended battery life to support daily tasks all day long.



Fingerprint Unlock

Easy and greater accessibility for seamless operations. Available for LTE version.



Built-in NFC module

Facilitates convenient, quick contactless payments to speed up the checkout process.



Specification

Processor	Octa core (Dual-core Arm Cortex-A76 2.2GHz	Display	10.95", 1920 x 1200		
	Hexa-core Arm Cortex-A55 2.0GHz)		Multi-point Capacitive Touch Panel		
Memory	4GB RAM + 64GB ROM	Operating System	Android 13, 64bit		
	8GB RAM + 128GB ROM				
Connectivity	Wireless: Wi-Fi 5, 802.11 a/b/g/n/ac (2.4GHz/5GHz)	Camera	2 MP front camera, 13 MP rear camera		
	Bluetooth 5.2, 2G/3G/4G LTE (Optional), GPS, NFC				
Speaker	1W Dual	Battery	Capacity: 3.8V / 8000mAh / 30.4Wh		
Environment	Operating temperature: -10 ~ 50°C	Certification*	Google GMS		
	Storage temperature: -20 ~ 60°C		FCC CE IMDA WEEE		
Dimensions	257.2 x 168.8 x 9mm	Weight	560g		
Button	Power key, Vol+ / Vol- key	Accessory*	Falcon 2 Case, Falcon 2 Payment Case, Secondary Display 5-inch		
			Basic Dock, 58mm Printer Dock, 80mm Printer Dock		
			80mm (Wireless) Printer Dock		
Printing	58mm Printer Dock	80mm Printer Dock		80mm (Wireless) Printer Dock	
	58mm width & 50mm diameter paper roll, up to 100mm/s	58mm/80mm width & 80mm diameter paper roll, with automatic cutter, up to 250mm/s		58mm/80mm width & 80mm diameter paper roll, with automatic cutter, up to 250mm/s	
Power Adapter	Falcon 2	Basic Dock	58mm Printer Dock	80mm Printer Dock	80mm (Wireless) Printer Dock
	Input: 100 ~ 240V	Input: 100 ~ 240V	Input: 100 ~ 240V	Input: 100 ~ 240V	Input: 100 ~ 240V
	Output: 9V / 2.22A	Output: 12V / 1.6A	Output: 24V / 2.5A	Output: 24V / 2.5A	Output: 24V / 2.5A
	Fast Charging PD20W				
Peripheral Ports	Falcon 2	Basic Dock	58mm Printer Dock	80mm Printer Dock	80mm (Wireless) Printer Dock
	USB Type-C (support OTG) x 1	USB Type-C x 1 (Charging only)	DC Jack x 1	DC Jack x 1	DC Jack x 1
	TF Card (up to 1TB) x 1	USB Type-A x 2	USB Type-A x 2	USB Type-A x 2	USB Type-A x 2
	Nano SIM x 1, eSIM (optional)	USB Type-A x 2	RJ12 x 1, RJ45 x 1	RJ12 x 1, RJ45 x 1	RJ12 x 1, RJ45 x 1
	Pogo pin (9 pin)	Pogo pin (9 pin)	Pogo pin (9 pin)	Pogo pin (9 pin)	Pogo pin (9 pin)
	Pogo pin (8 pin)				

* The product pictures and display contents in the above pages are for illustration purposes only. The actual product effects (including but not limited to appearance, color, size) and screen display contents (including but not limited to background UI pictures) might differ.

The performance results are obtained from iMin's internal laboratory and extracted from specific test environments. In actual use, there might be a difference in performance due to individual differences in product, software, use conditions and environmental factors.

The accessories of the Falcon 2 are sold separately according to user needs. To view more product certificate information, please visit www.imin.sg/en/resources.